

**MODEL: OT100-12**

**NO.: 302010005-00229**



**Plane Chart:**

Unit:(mm) Terminal type:(T3)

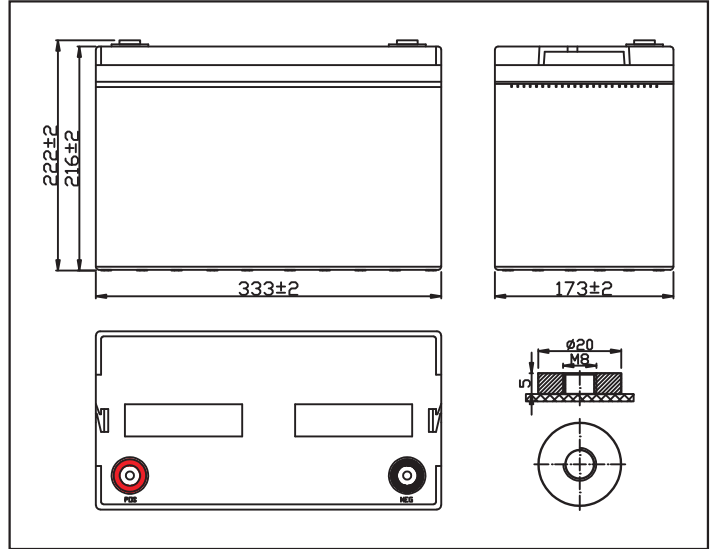

**Parameter Chart:**

| Volts                            |                                  | 12V  |  |
|----------------------------------|----------------------------------|--|--|
| Capacity(25°C)                   | 10 hours rate (10A)              | 100Ah  |  |
| Discharge Current Testing (25°C) | 1 hours rate (55A)               | 61Ah   |  |
|                                  | 3 hours rate (25A)               | 79Ah   |  |
| Internal Resistance              | Full Charged Battery 25°C        | 5mΩ  |  |
| Capacity Affected By Temperature | 40°C                             | 104%   |  |
|                                  | 25°C                             | 100%   |  |
|                                  | 0°C                              | 83%  |  |
|                                  | -15°C                            | 65%  |  |
| Residual Capacity (25°C)         | Capacity After 3 Months Storage  | 91%  |  |
|                                  | Capacity After 6 Months Storage  | 82%  |  |
|                                  | Capacity After 12 Months Storage | 65%  |  |
| Charge (Constant Voltage)        | Cycle (25°C)                     | Initial Charging Current Less Than 30A<br>Voltage 14.5~14.9V |  |
|                                  | Float (25°C)                     | Charge Voltage 13.6~13.8V                                    |  |
| Weight (Approx)                  |                                  | 30.5Kg   |  |

**Residual Capacity**

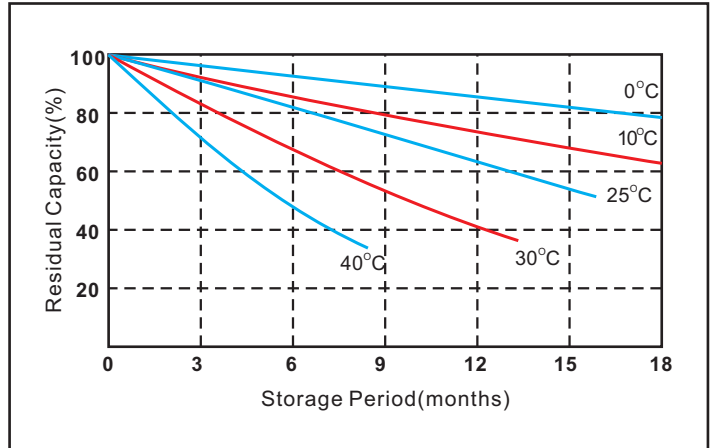

**Discharge Current 25°C**

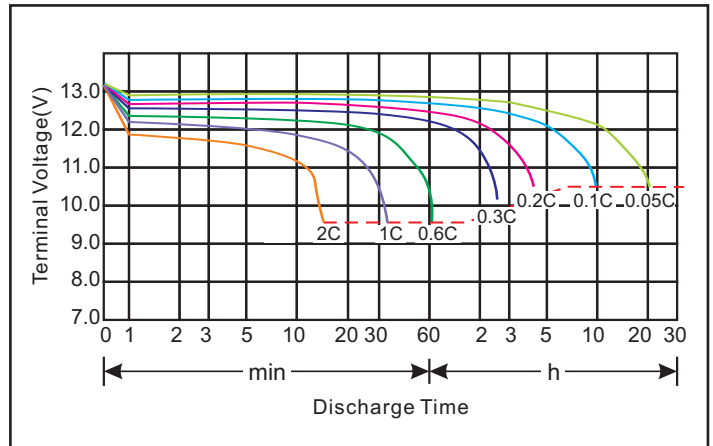

★The above are average and data obtained from the first 3 charge/discharge cycles. These are not minimum values.

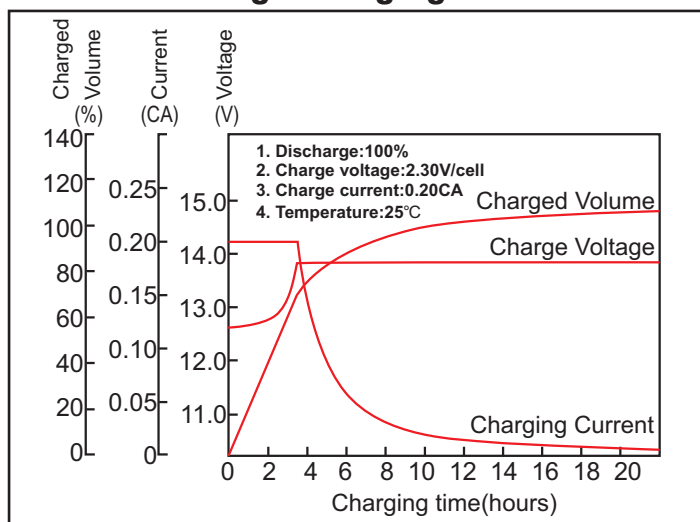
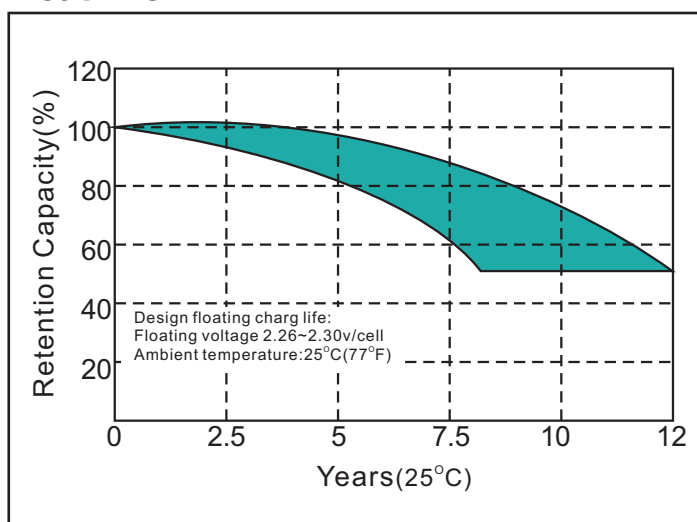
**MODEL: OT100-12**
**NO.: 302010005-00229**
**Constant voltage charging characteristics**

**Float Life**

**Constant Current Discharge Characteristics (A, 25°C)**

| F.V/Time | 10min | 15min | 30min | 60min | 2h   | 3h   | 5h   | 8h   | 10h  | 20h |
|----------|-------|-------|-------|-------|------|------|------|------|------|-----|
| 9.60V    | 217.8 | 172.8 | 106.9 | 61.2  | 36.1 | 26.1 | 18.3 | 12.0 | 10.2 | 5.3 |
| 10.2V    | 206.9 | 165.6 | 103.0 | 58.6  | 35.6 | 25.7 | 18.0 | 11.9 | 10.1 | 5.2 |
| 10.5V    | 196.8 | 160.2 | 100.0 | 57.2  | 35.3 | 25.5 | 17.8 | 11.8 | 10.0 | 5.2 |
| 10.8V    | 175.6 | 155.8 | 97.8  | 56.4  | 34.9 | 25.2 | 17.6 | 11.7 | 10.0 | 5.1 |

**Constant Power Discharge Characteristics (Watt, 25°C)**

| F.V/Time | 10min  | 15min  | 30min  | 60min | 2h    | 3h    | 5h    | 8h    | 10h   | 20h  |
|----------|--------|--------|--------|-------|-------|-------|-------|-------|-------|------|
| 9.60V    | 2352.2 | 1902.8 | 1199.9 | 733.6 | 418.8 | 306.9 | 216.8 | 144.5 | 121.8 | 64.3 |
| 10.2V    | 2234.4 | 1826.6 | 1155.3 | 703.9 | 412.8 | 302.9 | 212.9 | 143.9 | 120.8 | 63.6 |
| 10.5V    | 2204.2 | 1794.2 | 1149.9 | 657.8 | 408.9 | 300.0 | 209.9 | 143.6 | 119.8 | 63.4 |
| 10.8V    | 1984.3 | 1745.0 | 1115.1 | 643.0 | 404.9 | 297.0 | 207.9 | 142.6 | 118.2 | 63.0 |

**Capacity Factors With Different Temperature**

| Battery Type |     | -20°C | -10°C | 0°C | 5°C | 10°C | 20°C | 25°C | 30°C | 40°C | 45°C |
|--------------|-----|-------|-------|-----|-----|------|------|------|------|------|------|
| Battery      | 12V | 50%   | 70%   | 83% | 85% | 90%  | 98%  | 100% | 102% | 104% | 105% |

★The above are average and data obtained from the first 3 charge/discharge cycles. These are not minimum values.